



GIRALDA PLACE

RESIDENCES

RESIDENCE 6E

2 Bedrooms | 2.5 Bathrooms

Interior Area:

1,391 Sq. Ft. | 129 m²

Terrace/Balcony Area:

390 Sq.Ft. | 36 m²

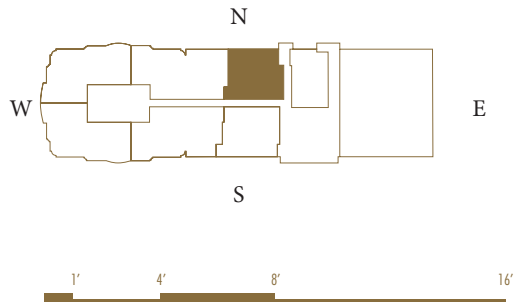

ORAL REPRESENTATIONS CANNOT BE RELIED UPON AS CORRECTLY STATING REPRESENTATIONS OF THE DEVELOPER. FOR CORRECT REPRESENTATIONS, MAKE REFERENCE TO THIS BROCHURE AND TO THE DOCUMENTS REQUIRED BY SECTION 718.503, FLORIDA STATUTES, TO BE FURNISHED BY A DEVELOPER TO A BUYER OR LESSEE.

Sketches, renderings, graphic materials, plans, specifications, terms, conditions and statements contained herein are proposed only and are subject to architectural and other revisions at the sole discretion of the developer, builder, architect, or as may be required by law. Floor plans may not be to scale. Any furniture, appliances or decorator ready items depicted herein are shown for artistic and illustrative purposes only and are not included in the purchase and sale of the residence. Dimensions are based on the definition of the unit as provided in the declaration and the Florida Administrative Code, as such they include only the interior airspace between perimeter walls and exclude interior structural components. However, measurements of the rooms set forth on any floor plan are generally taken from the greatest point of each given room (as if the room was a perfect rectangle), without regard for any cutouts. Accordingly, the area of the actual room will typically be smaller than the product obtained by multiplying the stated length times width. All dimensions are approximate and may vary from actual construction; all floor plans and development plans are subject to change. The renderings illustrate and depict a lifestyle, however, amenities, features and specifications are subject to change without notice. Buyers should check with the sales center for the most current pricing. This is not intended to be an offer to sell, or solicitation to buy condominium units where prohibited by law. All real estate shown herein is subject to the US Federal Fair Housing Act of 1998.